

AIRFRAME TRANSPORT - PART 1

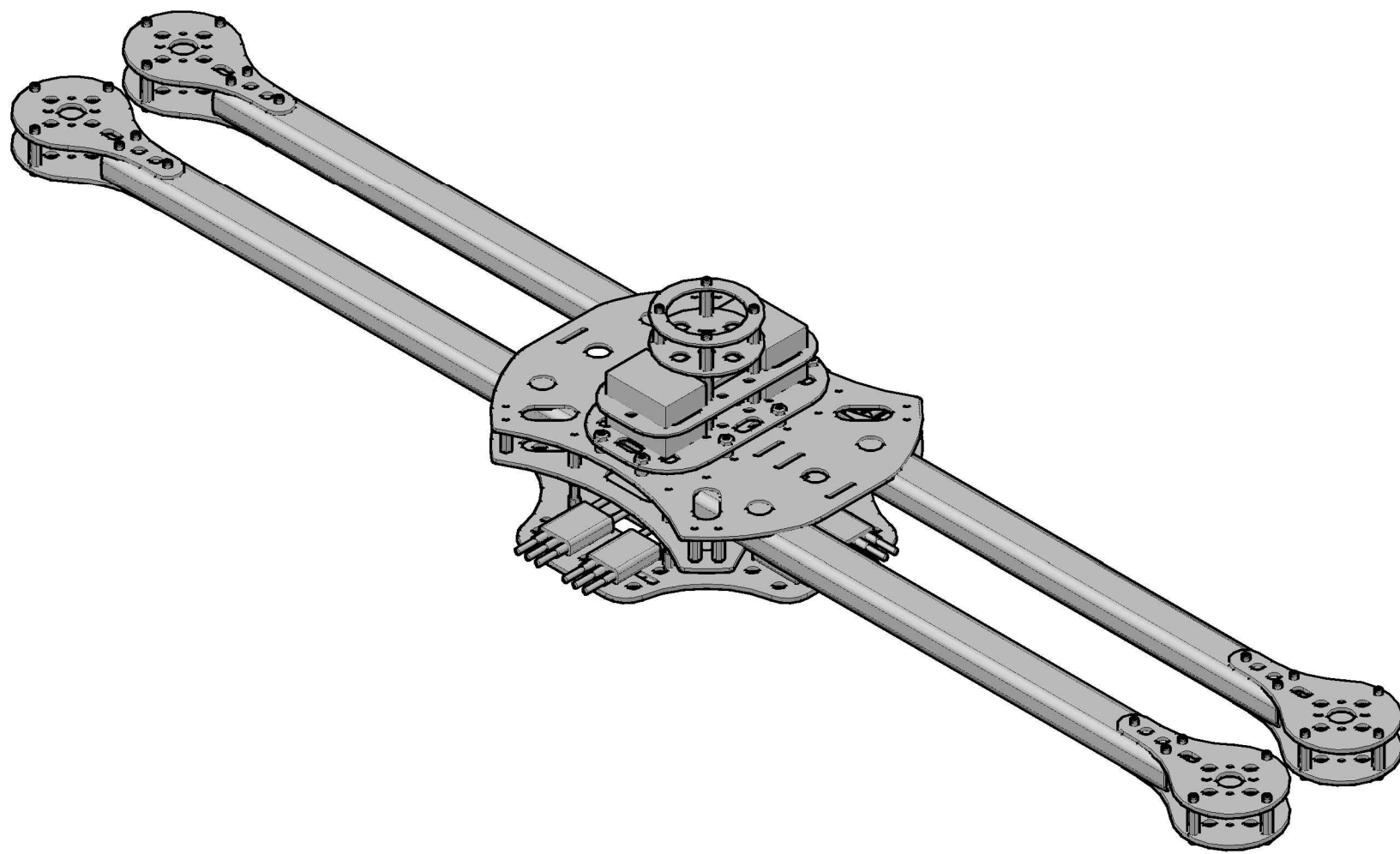

AIRFRAME TRANSPORT - PART 2

TRANSPORTING THE HQ-850 & HQ-1150

THE HEXACRAFTER HQ-850 & HQ-1150 ARE DESIGNED TO BE QUICKLY CONFIGURED TO BE PACKED IN A CARRYING CASE. WITH THE REMOVAL OF (8) 3MM X 35MM ARM LOCKING SCREWS ON THE ARMS, THE ARMS CAN ROTATE FOR PACKING OR TRANSPORT. THE LANDING GEAR, LOAD RAILS & ANY RAIL MOUNTED EQUIPMENT CAN BE REMOVED WITH AN ADDITIONAL (8) SCREWS. USERS CAN PROVIDE A PELICAN HARDCASE FOR PACKING THE FRAME ASSEMBLY FOR TRANSPORTATION & CHECKED LUGGAGE AIRLINE TRAVEL. LANDING GEAR, LOAD RAILS AND OTHER ACCESSORIES WOULD PACK NEATLY IN A SEPARATE PELICAN CASE OF THE REQUIRED SIZE FOR THE USER CONFIGURATION.

RECOMMENDED PELICAN CASES:

HQ-850 : PELICAN 1740

HQ-1150: PELICAN 1770

AIRFRAME TRANSPORT - PART 3

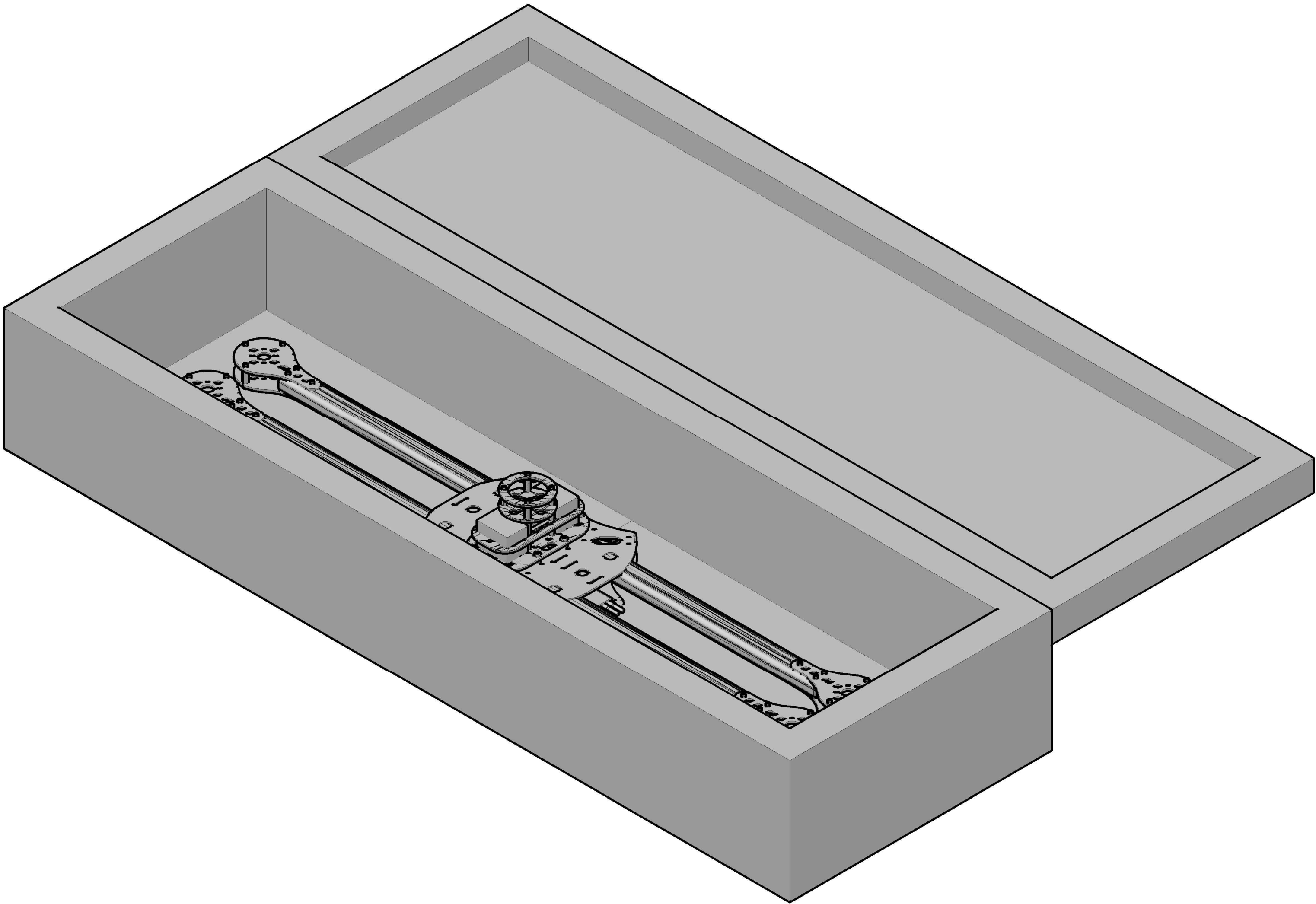

DRAWN BY:
ARR

ISSUE / DATE:
08-15-2015

REVISION :

SHEET TITLE :
HQ SERIES
AIRFRAME
ASSEMBLY
MANUAL- PAGE 1B

SHEET NO. :
QAF-1B